

Dial Indicators

SERIES 2 – Special Purpose Dial Indicators

Adjustable-hand dial gauge

- The hand position can be adjusted independently of the position of the plunger by rotating the top knob.

Peak-hold dial gauge

- A mechanism holds the pointer and the plunger at the position of maximum depression and hence displays the maximum value.*

* Clearance of peak hold: push the nut in the direction of the arrow indicated in the dimensions diagram for 2046S-80.

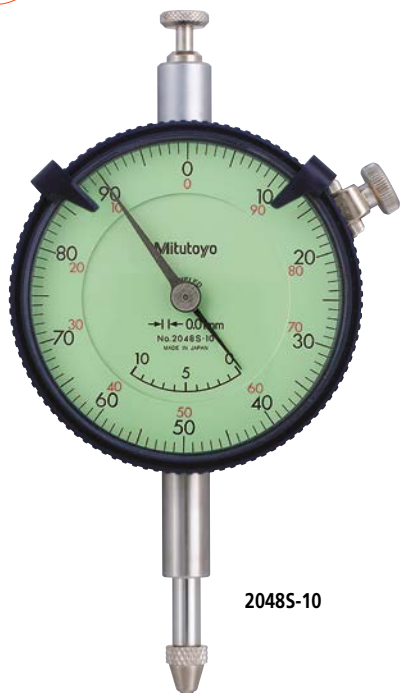

2048S-10



2046S-80

Specifications

Metric									
Code No.	Graduation	Range (range/rev)	Accuracy				Repeat-ability	Scale	Measuring force
			Overall	Retrace	1/10 rev	1 rev			
2048S-10	0.01 mm	10 mm (1 mm)	15 μm	3 μm	5 μm	10 μm	3 μm	0-100	1.4 N or less
2046S-80	0.01 mm	10 mm (1 mm)	15 μm	3 μm	5 μm	10 μm	3 μm	0-100	5.0 N or less

Inch									
Code No.	Graduation	Range (range/rev)	Accuracy			Repeat-ability	Scale	Measuring force	
			First rev / 2.5 rev / 10 rev	Retrace					
2915S-10	.001"	.5" (.1")	±.001" / ±.001" / ±.001"			±.0002"	0-100	1.8 N or less	
2918S-10	.001"	.5" (.1")	±.001" / ±.001" / ±.001"			±.0002"	0-50-0		

Dimensions

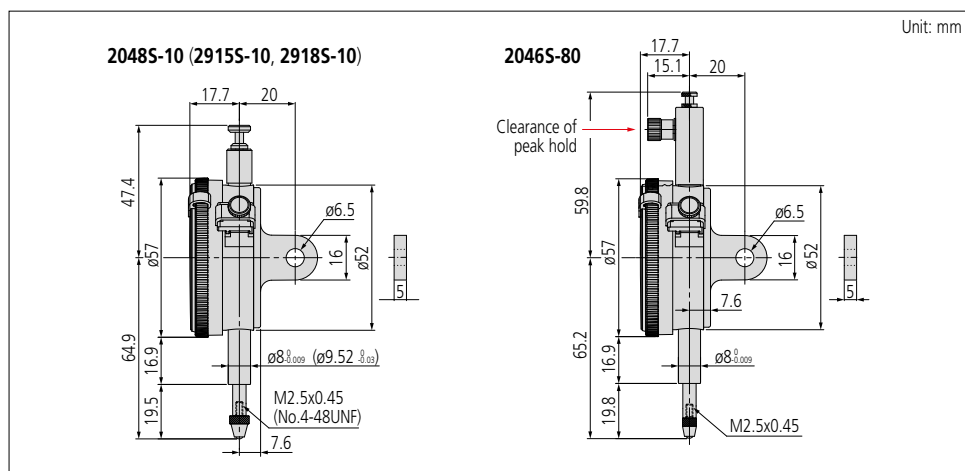

Features

Metric					
Code No.					
2046S-80	✓	—	—	✓	
2048S-10	✓	—	✓	—	

Inch					
Code No.					
2915S-10	✓	—	✓	—	
2918S-10	—	✓	✓	—	

Optional Accessories

Contact points for Mitutoyo's dial indicators refer to pages F-37 to F-40 for details.

Interchangeable backs refer to page F-41 for details.

Plunger lifting aids refer to page F-42 for details.

Measuring stands refer to pages F-67 to F-72 for details.